

Roll No.

[illegible]

Total No. of Pages : 03

Total No. of Questions : 05

B. Arch. (Sem.-9)

BUILDING CONSTRUCTION – VIII

Subject Code : AR-523

M.Code : 45065

Time : 4 Hrs.

Max. Marks : 100

INSTRUCTIONS TO CANDIDATES :

1. Attempt any **THREE** Questions in total.
2. One mark is reserved for neatness.
3. All Question carry equal marks.

- Q1. What is pre-stressing? Discuss the advantages and disadvantages of pre-stressing in Indian conditions.
- Q2. Draw the Working plan for the attached residence layout. Also draw schedule of the joinery and the construction details of one typical.
- Q3. Draw the construction details of the commercial Kitchen in attached drawing for a restaurant with 40 people's capacity.
- Q4. Differentiate through sketches the structural and non-structural curtain walls. Draw the typical construction details for a curtain wall of 9 mts width and 9 mts height.
- Q5. What is Modular construction? How the structural modules created for modular construction. List its advantages and disadvantages.

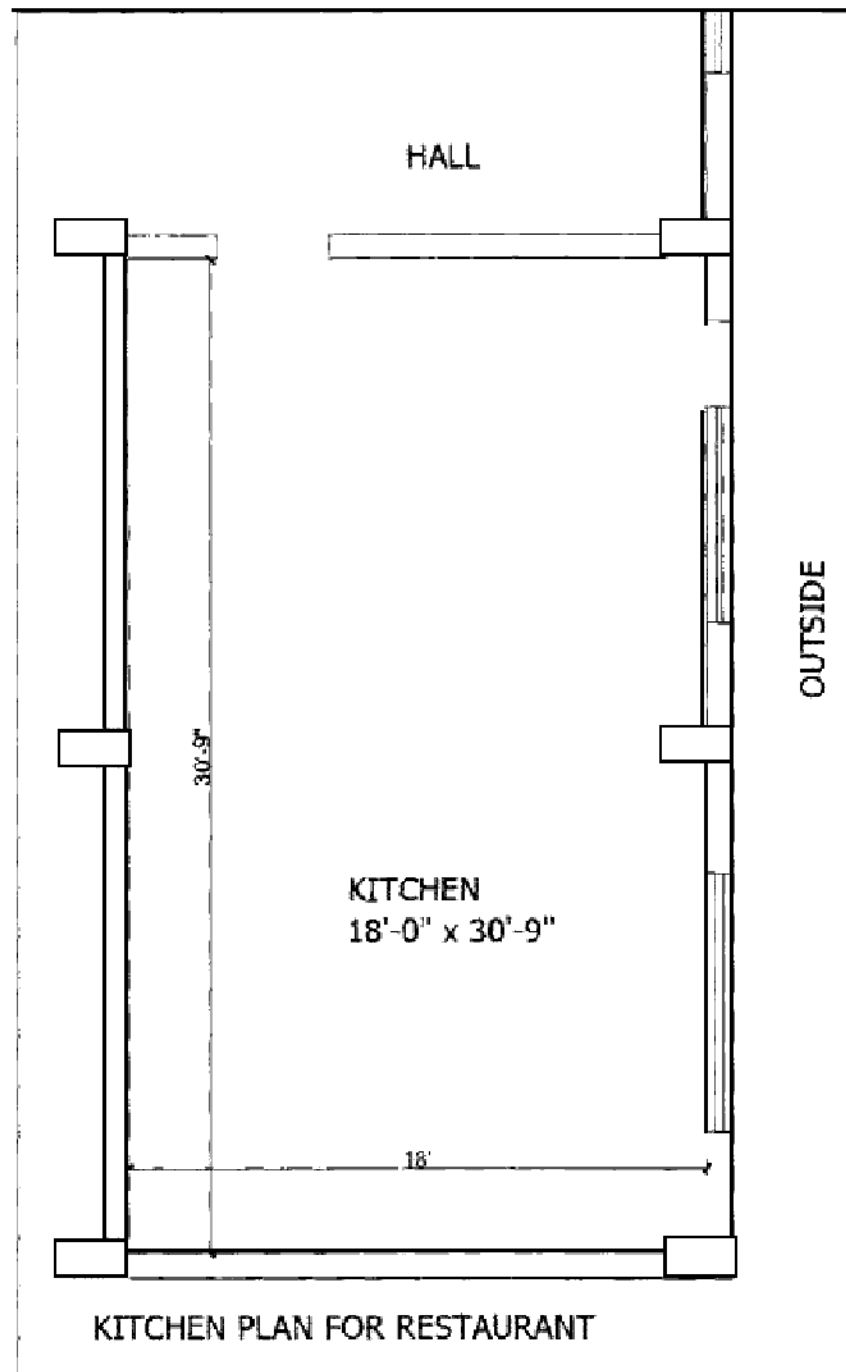

NOTE : Disclosure of identity by writing mobile number or making passing request on any page of Answer sheet will lead to UMC case against the Student.